

Stallion
CHROME SERIES

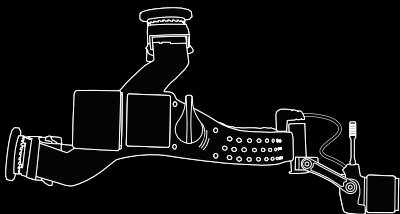

LED CORDLESS HEADLIGHT

INSTRUCTIONS FOR USE

SHL-9000 SERIES

WELCOME TO STALLION CHROME

Thank you for purchasing a Stallion Chrome surgical headlight system – the most advanced surgical headlight available. Please read these instructions and keep them for your reference.

Important Instructions: Failure to observe these very important instructions for use can result in injury, unforeseen consequences resulting from inappropriate use, product failure and warranty lapse. Do not tamper or change the labeling and/or this instruction for use.

Please read instructions carefully before using the product. Store in a safe place for future reference.

TABLE OF CONTENTS

Contact	10	Precautions	1
First Use	3	Relevant Standards	7
Limited Warranty	8	Routine Use	3
Miscellaneous Instructions	7	Safety Risks	1
Operation Instructions	3	Specifications	5
Parts & Accessories	9		

SAFETY RISKS, PRECAUTIONS, & CONTRAINDICATIONS

APPLIES TO STALLION HEADLIGHT, BATTERY, UNIT & 4-BAY DESKTOP CHARGER, Read/understand these safety requirements.

IMPORTANT NOTES: Batteries should be replaced every year. If the batteries swell, crack or get hot, DO NOT charge or use them. Discard them appropriately and replace accordingly. The battery used in this device may present a fire or chemical burn hazard if mistreated. In order to avoid damage to persons or property e.g. by electric shock, fire, ignition, explosion, leakage, or rupturing:

- ONLY USE the provided batteries and chargers for the headlight system purchased. VARTA Micro-battery Inc. Manufactures the batteries and therefore holds all claims, representations, and warranties. Bryton Corporation assumes no liability whatsoever and disclaims any express, implied or statutory warranty relating to its batteries and reserves the right to make changes to specifications and product descriptions at any time without notice.
- NOTE that it is recommended to leave the headlight charging when not in use. When disconnecting the power cord pull from the plug not the cord itself. When storing, remove batteries from unit and store in box they were supplied in.
- ONLY CHARGE/USE in environmental temperatures between 0 to +30°C.
- ONLY USE in environmental humidity between 65 +/- 20%RH.
- ONLY STORE in environmental temperatures between: 0 to +25°C.
- ONLY USE charger in dry locations in an isolated area. Keep away from rain, snow, flammables, excessive heat and/or moisture.
- DO NOT open battery, dispose of in fire, put in backwards, mix with used or other battery types, short circuit, disassemble, heat above 60°C (140°F), or incinerate.
- DO NOT handle damaged/leaking batteries. Dispose promptly and properly by following LiPO handling a safety precautions.
- DO NOT plug battery chargers into an extension cable.
- DO NOT forcibly bend power cord / place heavy objects on it; DO NOT pull, yank, or put stress on any of the wires.
- DO NOT operate if cord is severed or if batteries and/or 4-bay charger have been dropped or damaged.
- DO NOT use a damaged charger, disassemble or modify any part of the charger.
- DO NOT use an unauthorized power supply or charge a damaged battery.
- DO NOT allow metallic objects to contact the metal parts of the DC connectors in the charger ports or contacts of the battery.
- NOTE the headlight battery packs or 4-bay charger console may warm up during charge mode. The aluminum bezel / light engine also may get warm during use. This is normal and not a malfunction. Avoid skin contact to these areas during these times.
- NOTE that any changes, attempted self-repairs, or modifications not approved by Bryton Corporation will void any warranty on the unit and may inadvertently result in safety hazards and/or injuries.
- NOTE that these products are intended to increase visibility only and are not intended to come in contact with the patient.
- NOTE do not charge the batteries in the surgical field of use.

OPERATION INSTRUCTIONS

First Use:

1. Load Batteries, one on each side.
2. Charge overnight.
3. Turn on the light.
4. Place unit on head & adjust for head size.
5. Tune brightness to desired level.
6. Aim the beam hinges.
7. Select beam & spot size (varies by model).
8. Watch battery life LED's.

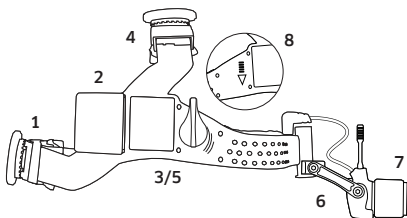

Routine Use:

Watch the battery life by referencing the five LED indicators located on the face of the left battery pack.

- Each chamber represents a ~20% portion of the accumulated battery life remaining. Note, the gauge may need up to a full discharge cycle to read the correct battery level.
- Change when there is only one indicator illuminated. Once all five of the indicators are depleted, there is a short period of time before the batteries are fully exhausted and the light turns off.

Charge the headlight. The USB charger takes **6.5 hours** when charging the batteries in the headlight. Plug the micro-B USB jack into the light and the standard USB end into either the 5V wall adapter or a computer USB port.

NOTE: The batteries should be used in pairs and should not be mixed and matched, particularly when using a charged battery with a dead battery or a new battery with an old battery.

When two batteries are correctly installed, they will charge/discharge simultaneously. When only one battery is connected/active, the battery indicator LED's will blink indicating to connect the second battery. It is recommended to leave the headlight on the charger while not in use with the rheostat powered off. When in storage, remove the batteries from the unit and store in safe location.

Batteries should be replaced every 12 months. If battery becomes hard to insert or remove, this means the batteries have swelled and use should be ceased immediately. Contact your representative to purchase additional batteries and dispose of used batteries responsibly.

4-Bay desktop charger. Keep spare batteries charged using this console.

A full charge is reached in **10 hours**. This charger is an accessory and may need to be purchased separately.

To use the 4-bay desktop charger:

1. Place the console in a safe location on a table top near a wall socket away from any spill or fire hazards.
2. Plug the charging cable in. Red/amber LED's will illuminate.
3. Insert the batteries into the slots. Ensure the batteries are keyed correctly and placed fully into each slot.
4. Indicator LED reference:

Blinking Green = Charging

Solid Green = Fully charged

Solid Red / Amber = Not installed or connected. Insert again fully.

Blinking Red = Battery fault - try a different battery.

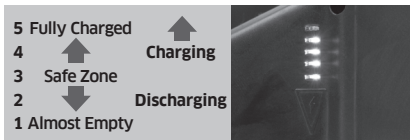

STALLION CHROME SPECIFICATIONS

General Headlight Specifications

The Light:

Brightness, spot see below MC7, MC6, and MC3 diagrams.

MC7

Spot Range: 90mm - 200mm

Brightness: 250,000 LUX

Battery Life: 3.5 hrs

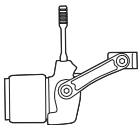

MC6

Spot Range: 70mm - 90mm

Brightness: 200,000 LUX

Battery Life: 6.75 hrs

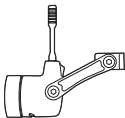

MC3

Spot Range: 10mm - 100mm

Brightness: 100,000 LUX

Battery Life: 7.75 hrs

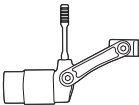

The Battery:

BATTERY CHARGE TIME IN LAMP: 6.5 hours

BATTERY CHARGE TIME IN 4-BAY DESKTOP

CHARGER: 10 hours

TOTAL BATTERY LIFETIME: Replace at least every 12 months.

Other:

BATTERY LIFE, WEIGHTS, AND OTHER INFORMATION: Refer to brochures.

LED COLOR TEMPERATURE: Reference between 5,000-6,500° Kelvin.

USING RHEOSTAT FOR POWER CHART

Bezel Kit	PWR LVL	Output @ 25cm	Output @ 45cm	Battery Life
MC3	25%	25,000 LUX	10,000 LUX	125 hrs
	50%	50,000 LUX	20,000 LUX	50 hrs
	75%	75,000 LUX	30,000 LUX	20 hrs
	100%	100,000 LUX	40,000 LUX	7.75 hrs
MC6	25%	50,000 LUX	20,000 LUX	108 hrs
	50%	100,000 LUX	40,000 LUX	44 hrs
	75%	150,000 LUX	60,000 LUX	18 hrs
	100%	200,000 LUX	80,000 LUX	6.75 hrs
MC7	25%	62,500 LUX	25,000 LUX	56 hrs
	50%	125,000 LUX	50,000 LUX	23 hrs
	75%	187,500 LUX	75,000 LUX	9 hrs
	100%	250,000 LUX	100,000 LUX	3.50 hrs

Position

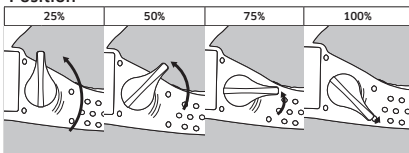

SPOT SIZE CHART

Bezel Kit	Working Distance	Small Spot Diameter	Expanded Spot Diameter
MC3	25cm / 10in to 46cm / 18in	3.5cm / 1.4in to 6.5cm / 2.5in	4.5cm / 1.75in to 8.5cm / 3.25in
MC6	25cm / 10in to 46cm / 18in	3.5cm / 1.4in to 6.5cm / 2.5in	4.5cm / 1.75in to 8.5cm / 3.25in
MC7	25cm / 10in to 46cm / 18in	3.5cm / 1.4in to 6.5cm / 2.5in	4.5cm / 1.75in to 8.5cm / 3.25in

MISCELLANEOUS INSTRUCTIONS

INSTRUCTIONS FOR USE: Please refer to the manufacturer or the authorized dealer if you have any queries regarding correct usage of a particular headlight.

Cleaning: Before cleaning, disconnect the charger from the device and power off completely. Avoid excessive moisture as this may cause serious damage to the security and present safety risks and void the warranty. The instrument housing may be cleaned with a soft cloth moistened with alcohol or a non-aggressive disinfectant solution. Do not soak or spray with disinfectant. The black padding strips may be removed for cleaning by pulling apart the snaps. The pads may be cleaned in the same way; do not soak or spray with disinfectant. New pads are available as accessories and should be routinely replaced.

Disposal: This product must be disposed of separately as an electronic device in accordance with the local regulations. Dispose of used batteries promptly and properly. In some regions, the disposal of lithium batteries in household or business waste may be prohibited. Kindly dispose of used batteries in a responsible manner.

Dentistry Application: A yellow filter may be used to prevent premature hardening of the composite material. Contact your sales rep for more information.

General Safety Precautions & Warnings: Do not shine headlight directly into anybody's eyes. Never hold microscopes or other optical lenses in front of the headlight. The LED light source is intense and has a high secondary exposure potential due to its blinding effect. Temporary reduction in visual acuity and afterimages can occur, leading to irritation, annoyance, visual impairment, and even accidents, depending on the situation. Use the rheostat for dimming to the appropriate setting. Do not use the bezel's aperture adjustment pin for adjusting beam angle. Pen intended for side-to-side motion only, not pivoting the bezel.

RELEVANT STANDARDS

CE Certified.

USB Wall Charger: IEC 61000.

Battery: UL 2054, EN 55014-2:1997+A1:2001, meets requirements of Battery Directives.

LED: IEC 62471:2006 - "Exempt" Group.

General: RoHS Compliant.

LIMITED WARRANTY

Warranty: 1 Year Manufacturers warranty. Check with your distributor for extended warranties.

Bryton Corporation (herein referred to as the "Manufacturer") warrants this unit (herein referred as "Product") as free from defects in materials and workmanship that result in Product failure during normal usage according to the following terms and conditions:

1. The Product labels and/or these instructions for use are not to be removed or modified as it comes from the Manufacturer.
2. The limited warranty extends only to the original end-user purchaser and holder of the warranty and is not transferable or assignable to another third party.
3. This limited warranty is ONLY applicable in the country or territory where the product was purchased from the Manufacturer's authorized headlamp retailer and is valid ONLY if used and returned with original headlamp contents/accessories.
4. During the Warranty Period, the Manufacturer will repair or replace, at its sole option, any defective parts that will not operate for their intended purpose with a new or refurbished parts if such repair or replacement is needed.
5. This limited warranty does NOT apply to:
 - a. The carrying case and accessories (batteries, charger, and other items included in the kit other than the headlight unit).
 - b. Damage caused by abnormal wear and tear, abnormal use or conditions, misuse, neglect, abuse, accident, improper handling or storage, unauthorized modifications, alterations, or repairs not performed by a certified technician, improper use of any electrical source-or third-party battery, operator error, non-compliance with instructions or other acts which are not the fault of Manufacturer, including damage or loss during shipping. Further claims are excluded.
 - c. Any product that has its labels or serial number altered, defaced or removed.
 - d. Any defect that occurred after the expiration of the Warranty Period.
6. The Manufacturer's limit of liability under the Limited Warranty is limited to the actual cash value of the Product at the time you return the Product for repair.
7. THE FOREGOING LIMITED WARRANTY IS YOUR SOLE AND EXCLUSIVE REMEDY AND IS IN LIEU OF ALL OTHER WARRANTIES, EXPRESS OR IMPLIED, TO THE EXTENT PERMITTED BY APPLICABLE LAW. THE MANUFACTURER HEREBY DISCLAIMS THE APPLICABILITY OF ANY IMPLIED WARRANTY OF FITNESS OF USE FOR THE PRODUCT.
8. THE MANUFACTURER WILL NOT BE RESPONSIBLE FOR ANY INDIRECT, INCIDENTAL, SPECIAL PUNITIVE OR CONSEQUENTIAL DAMAGES ARISING FROM OR RELATING TO THE USE OF THIS PRODUCT.
9. IT IS REQUIRED TO DISINFECT the headlamp before returning for repair.

PARTS & ACCESSORIES

SHL-9000	Kit w/ all 3 bezels mounted on Stallion SLIMSTRAP™ headband
SHL-9000-HK	Stallion Chrome Premium Hospital Headlight kit
SHL-9300	100,000 LUX mounted on Stallion SLIMSTRAP™ headband
SHL-9300-HK	Stallion Chrome Premium Hospital Headlight kit
SHL-9600	200,000 LUX mounted on Stallion SLIMSTRAP™ headband
SHL-9600-HK	Stallion Chrome Premium Hospital Headlight kit
SHL-9700	250,000 LUX mounted on Stallion SLIMSTRAP™ headband
SHL-9700-HK	Stallion Chrome Premium Hospital Headlight kit
SHL-9000-B2	Battery Set. For Stallion Chrome.
SHL-9000-CUS	Charger Wall Unit (US). 5V@1A UPS Charger & USB Cable.
SHL-9000-C	Charger Wall Unit Int'l (US/EU/UK/AU). 5V@1A UPS Charger & USB Cable.
SHL-9000-CC	Charger USB Cable (Only).
SHL-9000-DC4RCUS	Charger 4-Bay Desktop Console (US). 4-Bay Dock, Wall Plug, & USB Cable.
SHL-9000-DC4RCINTL	Charger 4-Bay Desktop Console (Int'l). 4-Bay Dock, Wall Plug w/ Int'l Plug Clips, & USB Cable.
SHL-8000-MX	Magnifier +2D (X=1); +2.5D (X=2); +3D (X=3); +3.5D (X=4); +4.0D (X=5); +4.5D (X=6). For Stallion MC3.
SHL-9100-MX	Magnifier +2D (X=1); +2.5D (X=2); +3D (X=3); +3.5D (X=4); +4.0D (X=5); +4.5D (X=6). For Stallion MC5 & MC7.
SHL-9000-RP	Padding Set. For Stallion Chrome.
SHL-9000-CS	Case. For Stallion Chrome.
SHL-9000-AF	MC3 Filter. Amber filter for composite curing prevention.
SHL-9000-RHS	Head-strap. Replacement head-strap for Stallion Chrome units.
SHL-9000-MC3	Bezel MC3. Replacement bezel for the Stallion Chrome MC3 unit.
SHL-9000-MC6	Bezel MC6. Replacement bezel for the Stallion Chrome MC6 unit.
SHL-9000-MC7	Bezel MC7. Replacement bezel for the Stallion Chrome MC7 unit.

CONTACT BRYTON CORPORATION

**For product questions or to place an order,
please contact:**

Bryton Corporation

4011 Championship Dr. Indianapolis, IN 46268

Phone: 1-800-567-9500

Web: www.brytoncorp.com

Email: info@brytoncorp.com



CORDLESS FREEDOM™

Bryton Corporation
4011 Championship Dr. Indianapolis, IN 46268
Phone: 1-800-567-9500
Web: www.brytoncorp.com
Email: info@brytoncorp.com

©2017 Bryton Corporation